

CHEMIPON[®]N

Series NFH

Solenoid Driven Metering Pump



**Safe · Precise
Compact**

Solenoid Driven Metering Pump - Series NFH

The series NFH is a solenoid driven metering with the concept of the user-friendly design. Our technology makes the pump with reliable feeding performance. The feeding capacity can be adjusted via stroke length and stroke frequency to obtain a satisfied turn-down ratio.

■ The wide voltage circuit design.
1Ø100V~240V+/-10%
It makes the pump can be used everywhere.

■ The water / dust proof design
Equivalent to protection IP65

■ Safety device for solenoid.
The solenoid with thermostat always makes the pump running safely.

■ Easy to read the LCD display
The LCD display shows the operation status clearly.

Manual air vent valve

At the time of start-up, the retained gas in the pump head or suction hose can be expelled by rotating the air vent valve.



PVDF body



360° Rotation

The pump can be rotated on the base through 360°



Stroke length adjusting dial

Stroke length of the pump can be adjusted in a range from 50 to 100% by turning the dial.



Touch keys

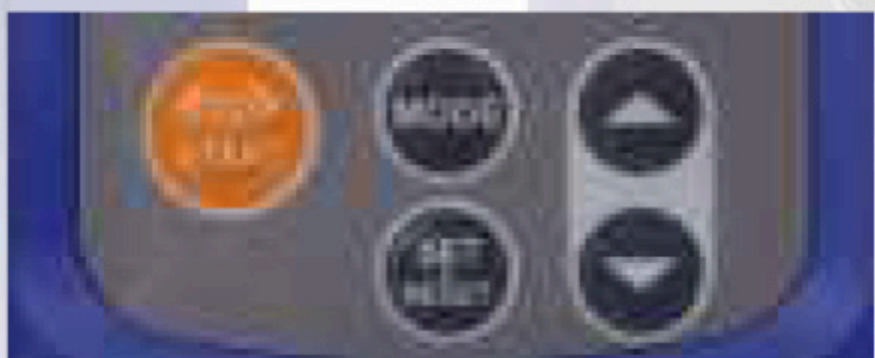

- Stop / Start key
- Mode setting key
- LCD indication selected key



Performance Curves

NFH100

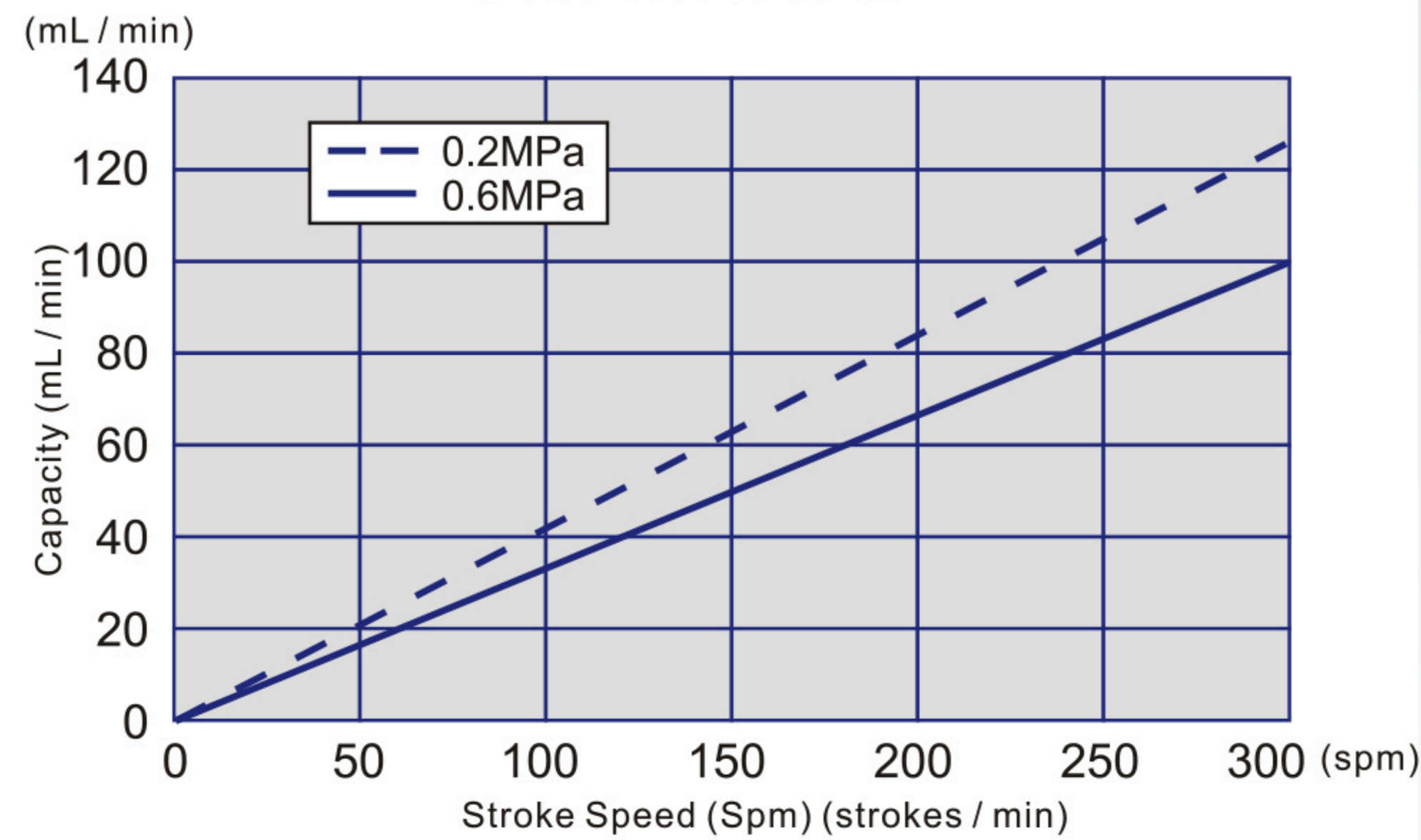

NFH200

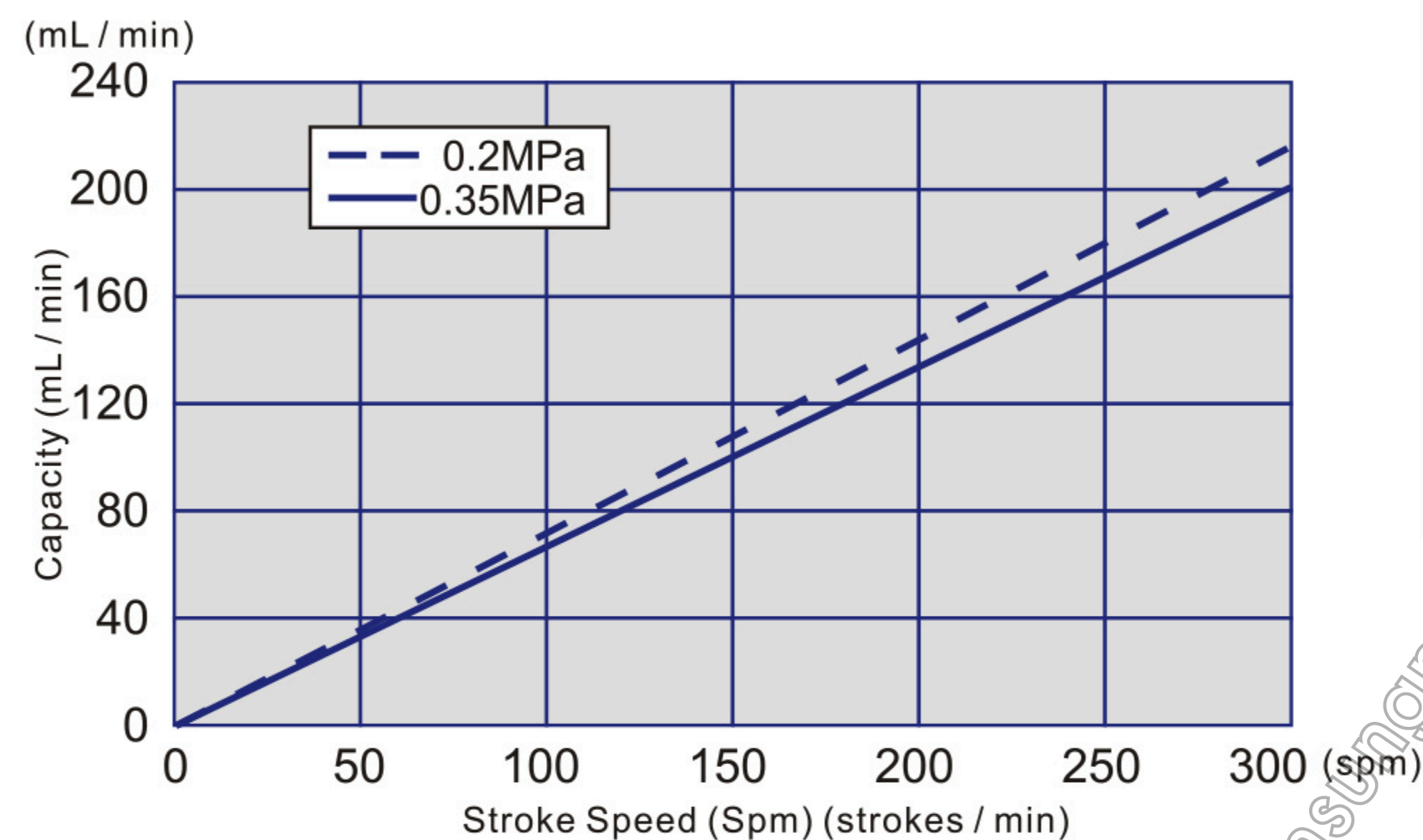

※ Performance curves may vary by location and conditions. The flow rate should be adjusted according to flow rate measurements based on use conditions.

Specifications

Pump Model	NFH100	NFH200
Max. Discharge capacity ml/min	100	200
Max. Discharge pressure (MPa)	0.6	0.35
Connecting hose for suction and discharge	PVC braided hose $\varnothing 6 \times \varnothing 11$	
Connecting hose for air vent	PVC hose $\varnothing 4 \times \varnothing 6$	
Number of strokes	1 to 300spm digital indication	
Stroke length adjusting range	50~100%	
Power source	50/60Hz AC100~240V $\pm 10\%$	
Max. Current at ON	3.7A	
Average power consumption	22W	
Protecting type	Equivalent to Ip65	
Discharge accuracy	Within $\pm 2\%$ (at max. Discharge rate)	

※ Install and anti-siphon check valve to observe stable folw from the pump.

Liquid Ends

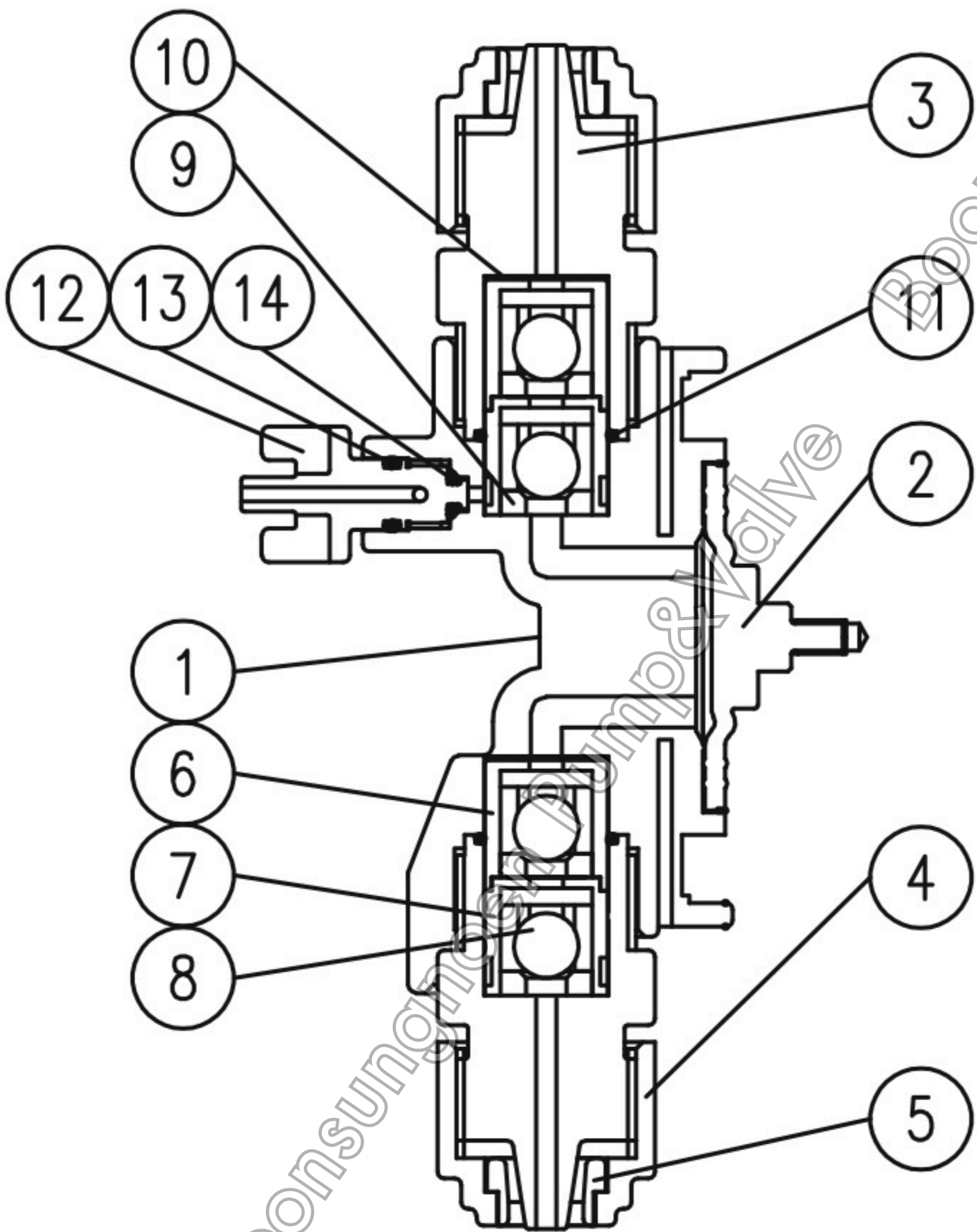

NO	Component name	Maternal	Q'ty
14	O-ring	FPM / EPDM	1
13	O-ring	FPM / EPDM	1
12	Air vent valve	PVDF	1
11	O-ring	FPM / EPDM	1
10	Gasket	PTFE	2
9	Valve seat	FPM / EPDM	4
8	Ball valve	CE	4
7	Ball guide B	PVDF	2
6	Ball guide A	PVDF	2
5	Union nut collar	PVDF	2
4	Union nut	PVDF	2
3	Hose joint	PVDF	2
2	Diaphragm	PTFE / CR	1
1	Diaphragm head	PVDF	1

Model Code

NF	H	100	-	D	M	T	-	M	
①	②	③		④	⑤	⑥		⑦	⑧

- ① Pump Series
NF : NF
- ② Solenoid
H : 22W
- ③ Pump Size
100 : 100ml/min
200 : 200ml/min
- ④ Diaphragm Head
Material
D : PVDF
M : SUS316
T : PTFE
- ⑤ Ball Valve
C : Ceramic
M : SUS316
- ⑥ Material of Valve Seat and O-ring
E : EPDM
F : FPM
T : PTFE (Special fluorine-contained rubber)
- ⑦ Circuit
M : Standard
P : Multi-fuction Pulse input control
A : Multi-fuction Analog input control
- ⑧ Special Indication
None : Standard
SP : Special Specification

Solenoid Driven Metering Pump - Series NFH

Dimensions

Unit:mm

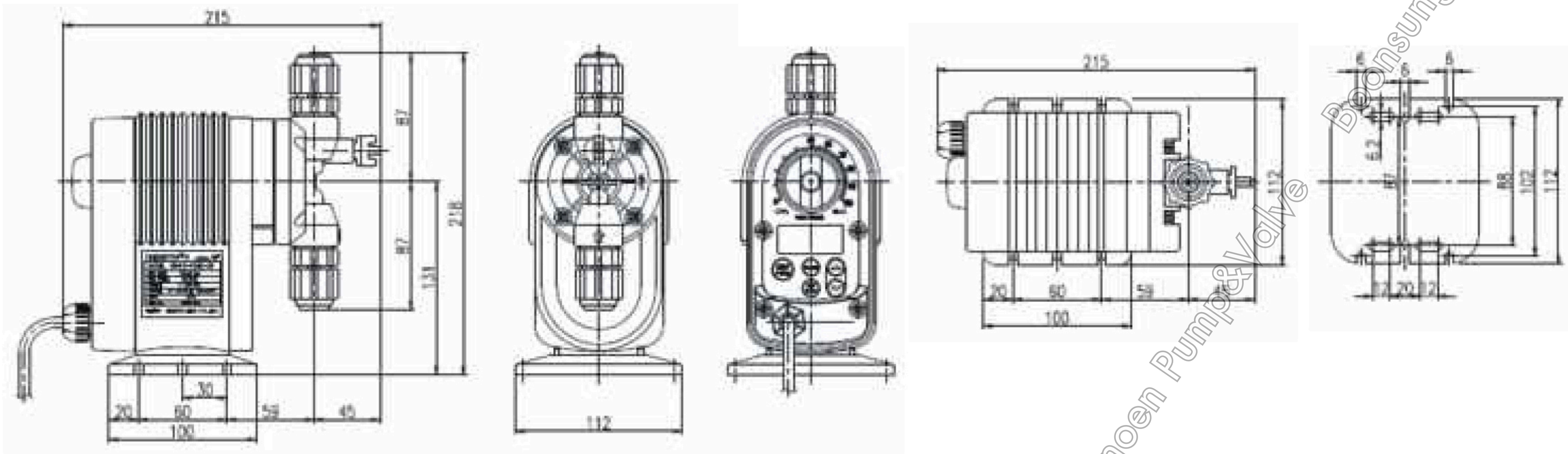

Accessories



	Name	Model	Applicable Pump
Standard Accessories	Injector	D0AC700	NFH 100/200
	Filter	D0FI064	NFH 100/200
	Suction/Discharge Hose	Ø 6 X Ø 11 3 Meter	
	Air Vent Hose	Ø 4 X Ø 6 1 Meter	
Optional Accessories	Anti siphon check valve	B55 P V	NFH 100/200
	Foot Valve	B63 P V	NFH 100/200

Multiple Function Type

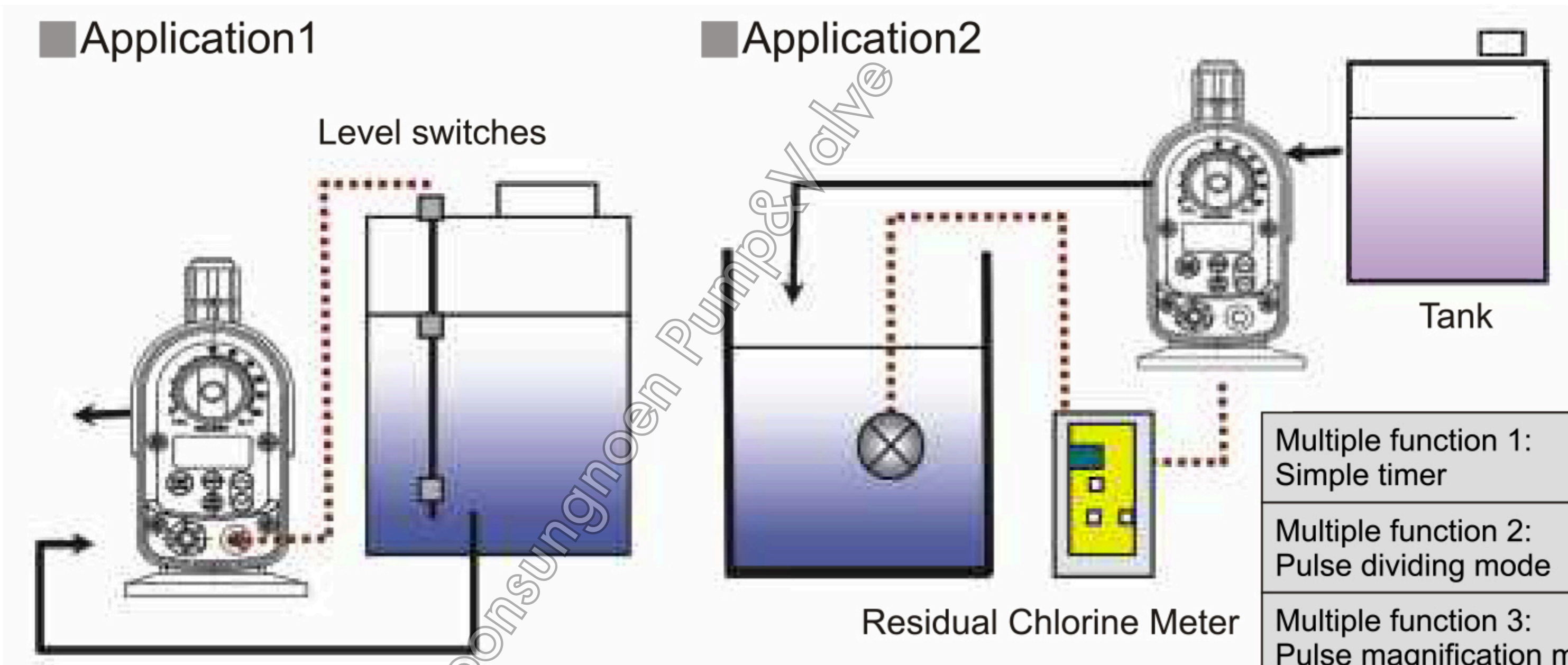

Multiple function 1: Simple timer	ON/OFF intermittent setting range 1-9999 seconds 1-9999 minutes, 10-9999 minutes
Multiple function 2: Pulse dividing mode	No-voltage 1/9999-1 pulse: 1 stroke
Multiple function 3: Pulse magnification mode	No-voltage 1 pulse: 1-9999 stroke
Multiple function 4: External contact input	Up to two of no-voltage contacts can be input

※Please contact us for the details.

SHUN EIKO CO., LTD.

NO.11, KUNG ERH RD., LINKOU DIST,
NEW TAIPEI CITY, TAIWAN
TEL: 886-2-26015831
FAX: 886-2-86011017